

What is the Northumberland Line?



The Northumberland Line will bring passenger trains back into service between Ashington and Newcastle. It is a priority of both Northumberland County Council and is supported by a number of key project partners, including the Department for Transport, Network Rail, Transport for the North, Nexus, Northern Trains Limited, North Tyneside Council, North of Tyne Combined Authority and Newcastle City Council.

The project will provide six new stations at Ashington, Blyth Bebside, Bedlington, Newsham, Seaton Delaval and Northumberland Park, with journeys between Newcastle and Ashington taking about 35 minutes with no need to change trains.

The station at Northumberland Park will be adjacent to the existing Tyne and Wear Metro station, bringing further opportunities for interchange and travel to other destinations, including on the Metro. We are exploring options for integrated ticketing between the two services.

At Newcastle station it is anticipated that Northumberland Line trains will run into platform one, with easy access to the city centre, Tyne and Wear Metro and national rail connections.

The freight trains that currently use the railway will still be able to do so, helping support the economic aspirations of both Lynemouth Power Station and the Port of Blyth.



"I'm delighted that the re-introduction of direct passenger trains between south-east Northumberland and the centre of Newcastle in the next three years is nearer than ever. It's been a long-held ambition of this council to get trains running again on the Northumberland Line and over recent years we've made a great deal of progress. There's ever more confidence our long-term aspirations are going to become reality - bringing social and economic benefits to residents, commuters, visitors and businesses both in Northumberland and the wider region."

- Glen Sanderson, Leader of Northumberland County Council

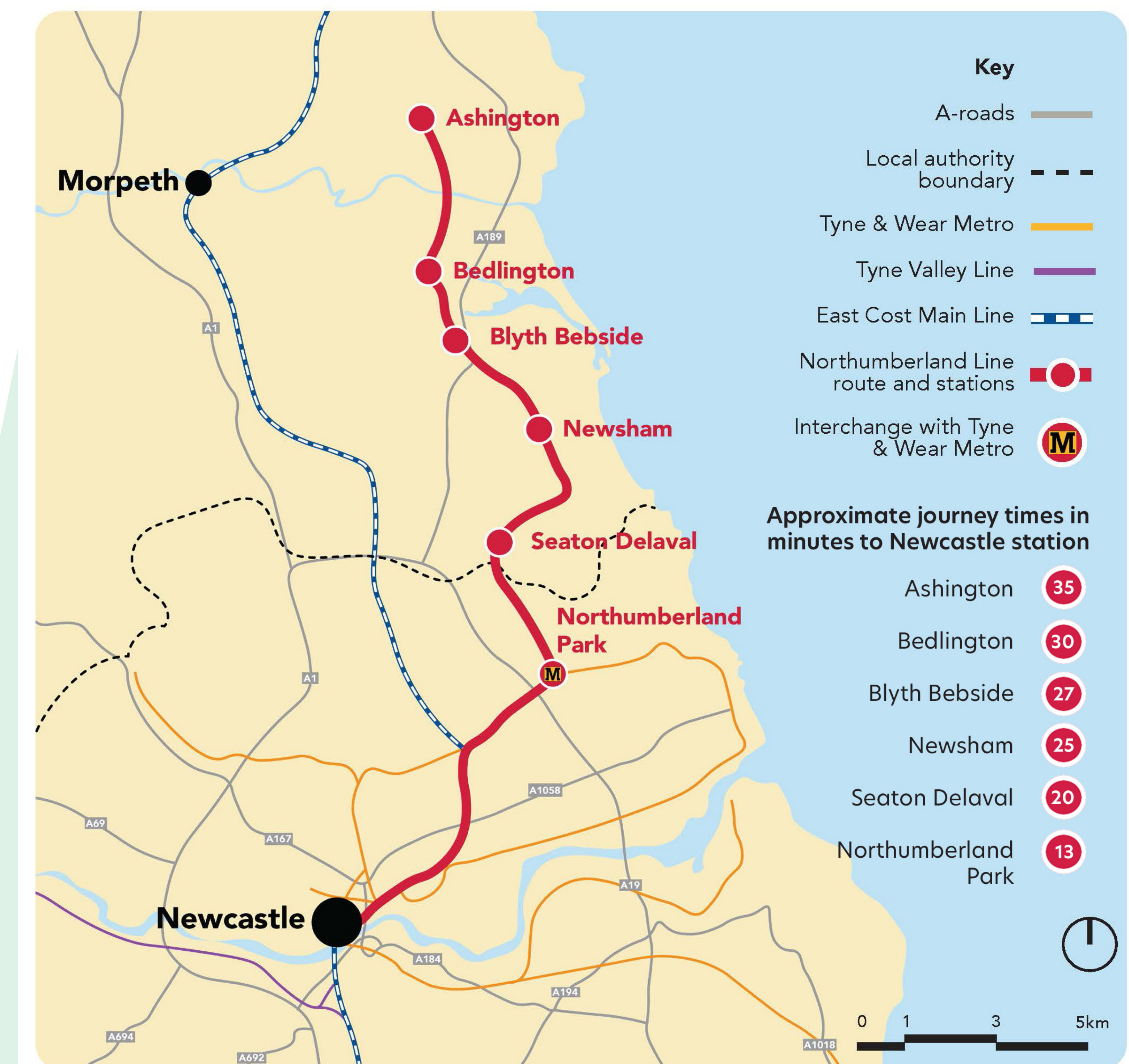

Facilities at Northumberland Line stations



Ticket machines



Seating and shelters



Audio frequency induction loops



Car parking



CCTV cameras



Bike parking

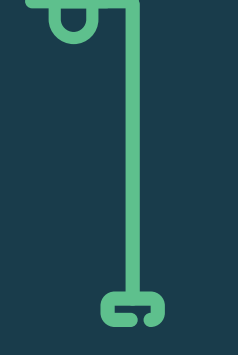

Lighting

Northumberland Line route and facilities

Benefiting local communities



The Northumberland Line aims to stimulate and support economic growth, regeneration and community development in Northumberland and the surrounding regions by providing new and improved transport links for local people and businesses.

We want local communities and businesses to be actively involved in the scheme, providing a sense of ownership and pride. We are aiming to foster this through employment and learning opportunities, enhancing the profile and perceptions of the local area, supporting communities to engage with the railway and the opportunities it brings, and creating an identity for South East Northumberland as an attractive place to live, work, visit and enjoy.

Scheme benefits



Improving access from towns such as Ashington and Blyth to employment hubs like Newcastle, as well as opening up new opportunities for education and travel.



Providing a real incentive for employers to relocate to and invest in the area.



Providing vital infrastructure to help deliver the region's aspirations for population and economic growth.



Helping to attract visitors and improve local tourism.



Enhancing public transport connectivity within and beyond the region.



Helping to reduce congestion and improve air quality on key corridors by moving people away from car travel and onto public transport.



Supporting the delivery of significant growth in sectors such as renewable energy, offshore oil and gas and engineering.

Community activities



Creating apprenticeships and work experience placements for local people.

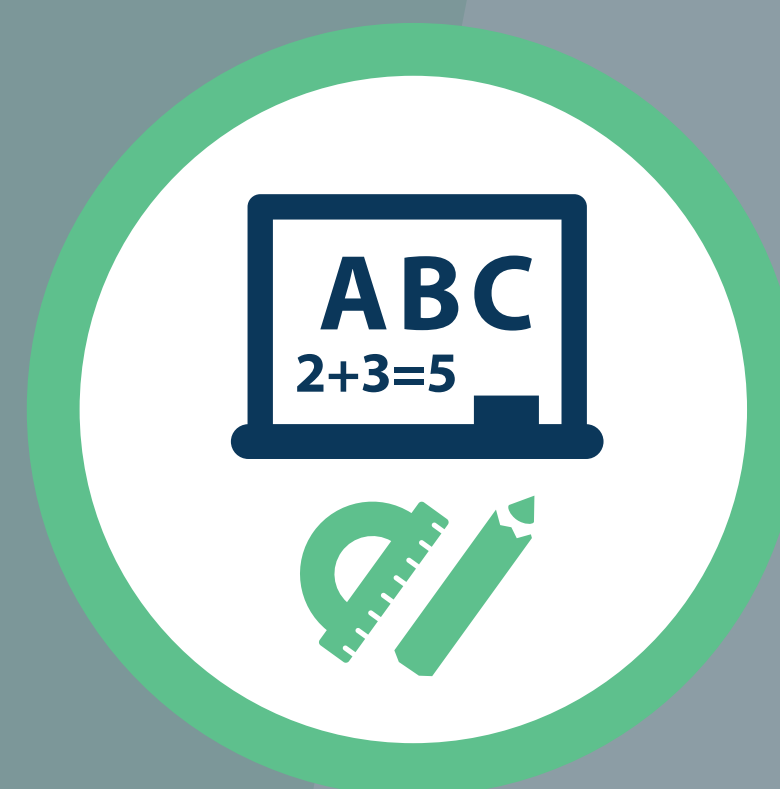

Delivering sessions in local schools, and providing educational resources linked to the railway.



Employment workshops delivered by Northern Trains Limited, and targeted construction skills training programmes.



Volunteering with local schools and organisations.



Heritage, history and local arts initiatives to capture, document and celebrate industrial history locally.



Opportunities for station adoption groups.



Future development of a Community Rail Partnership for the line.

If you're interested in getting involved, visit our dedicated Northumberland Line website for details of work in schools, rail safety training, current job vacancies and ways you can support the project.

How Blyth Bebside station could look

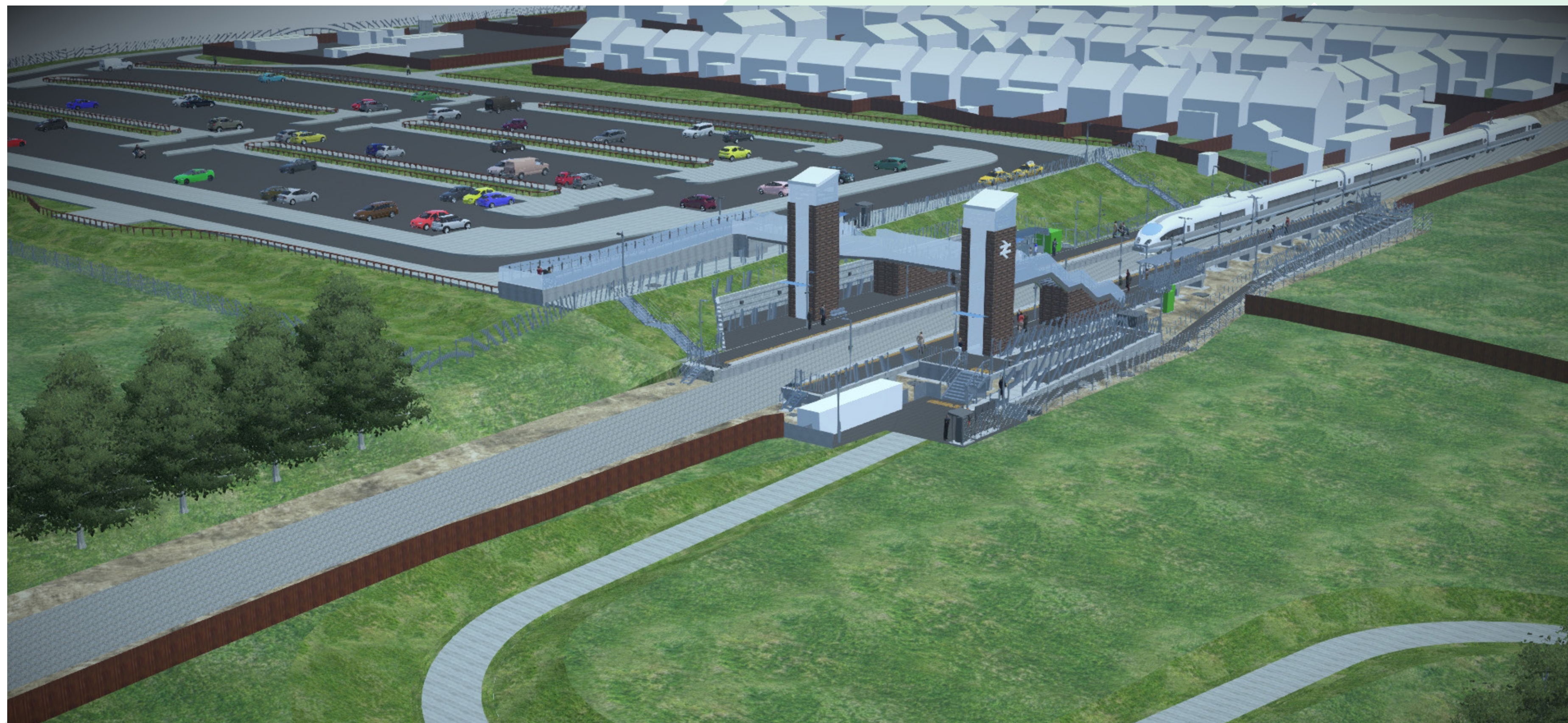

Aerial view of Blyth Bebside station looking west, with the path leading to the station from the new bridge over the A189 in the foreground and the station, footbridge between platforms and customer car park in the background

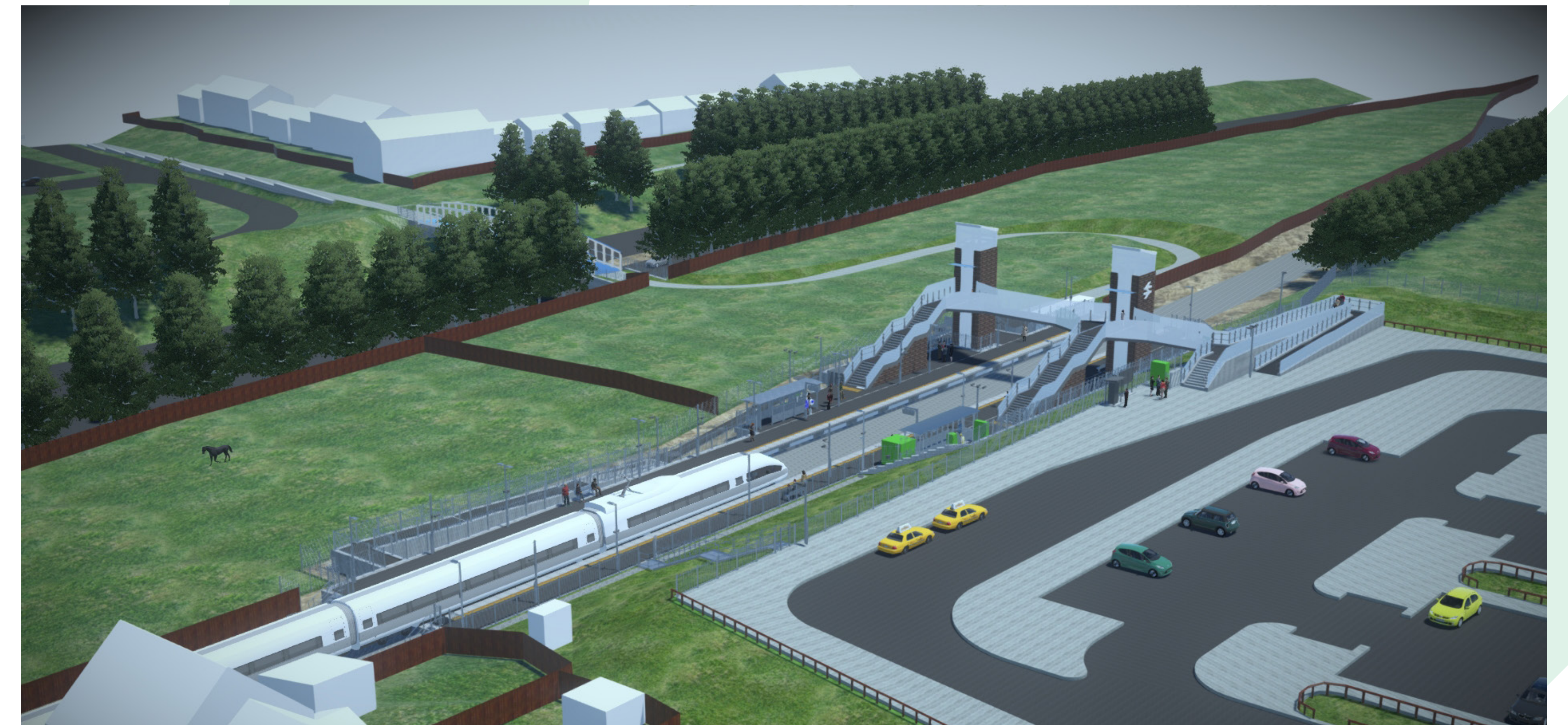

View of Blyth Bebside station looking east

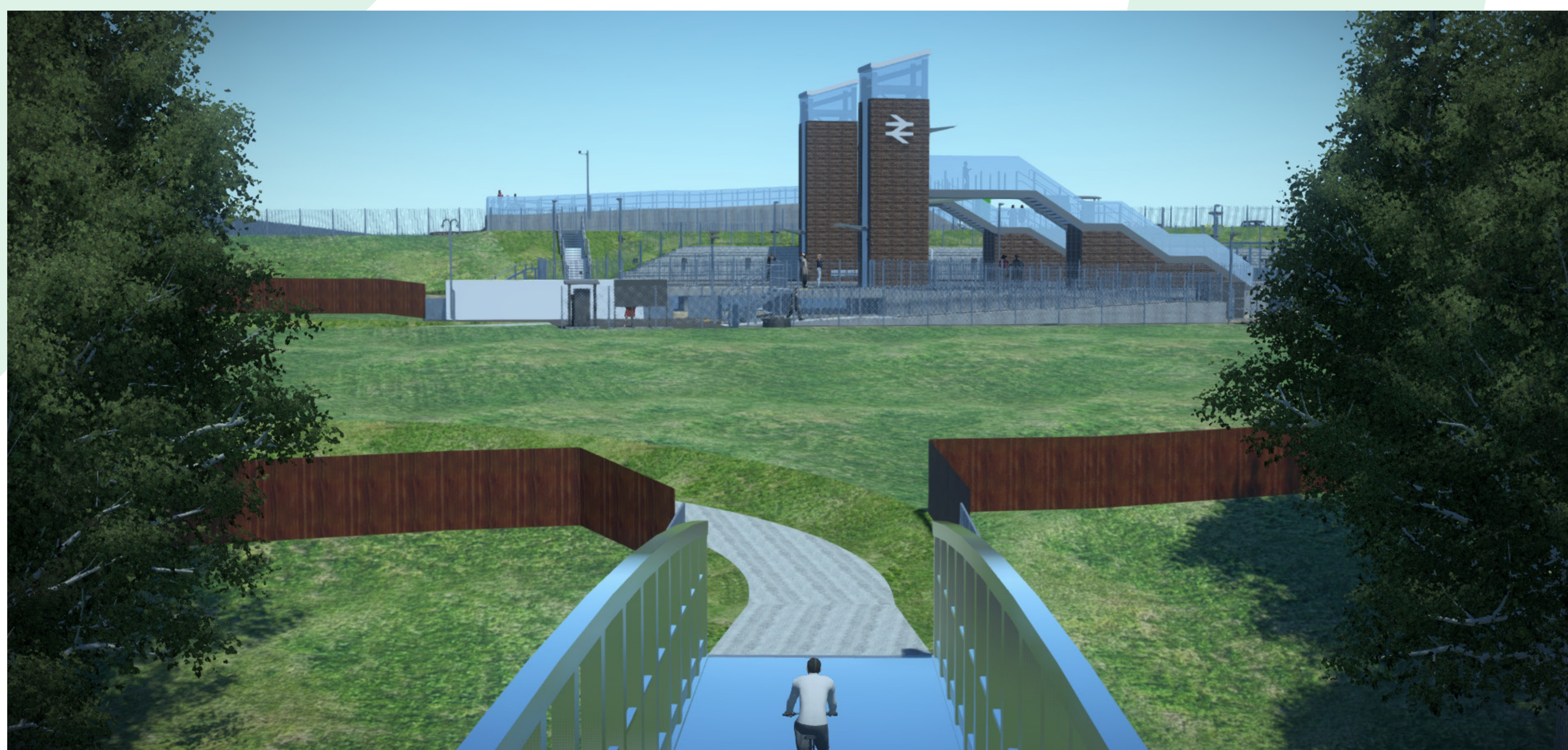

View of Blyth Bebside station from the east, from the a pedestrian and cycle bridge over the A189

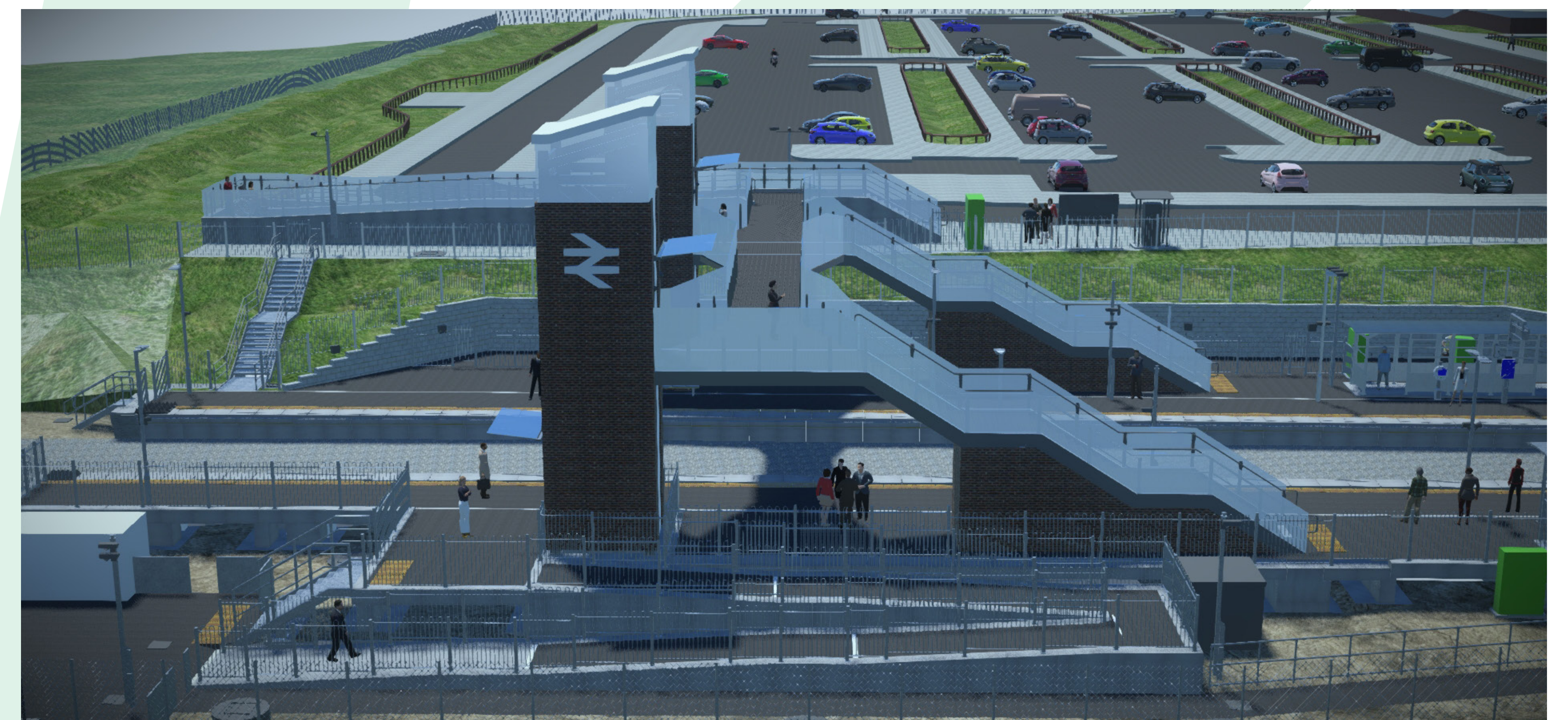

View of Blyth Bebside station looking west. Station facilities such as ticket machines and platform shelters can be seen

How Newsham station could look

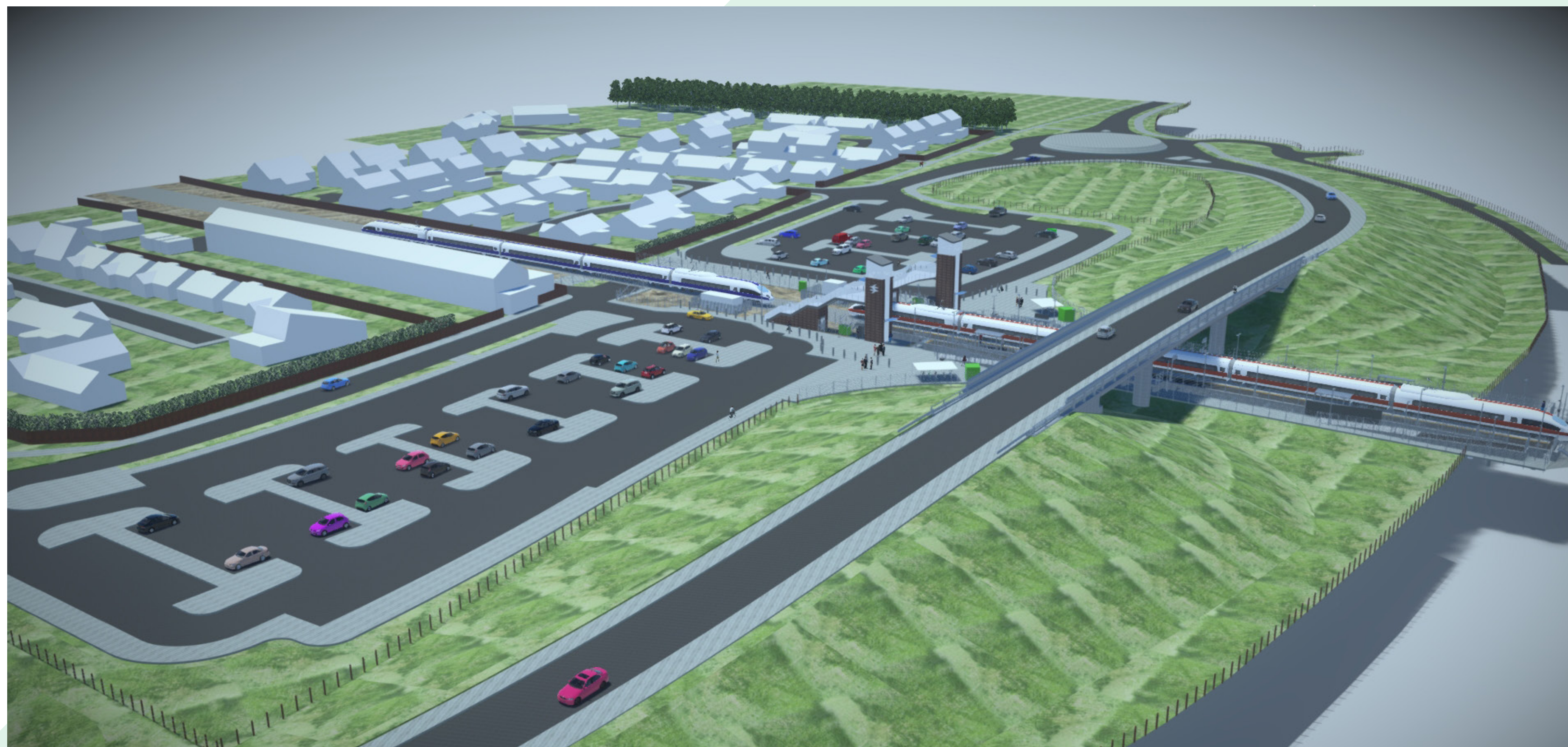

Aerial view of Newsham station, including the station car park and new highway bridge over the railway



View of Newsham station from the south, with the station car park in the foreground

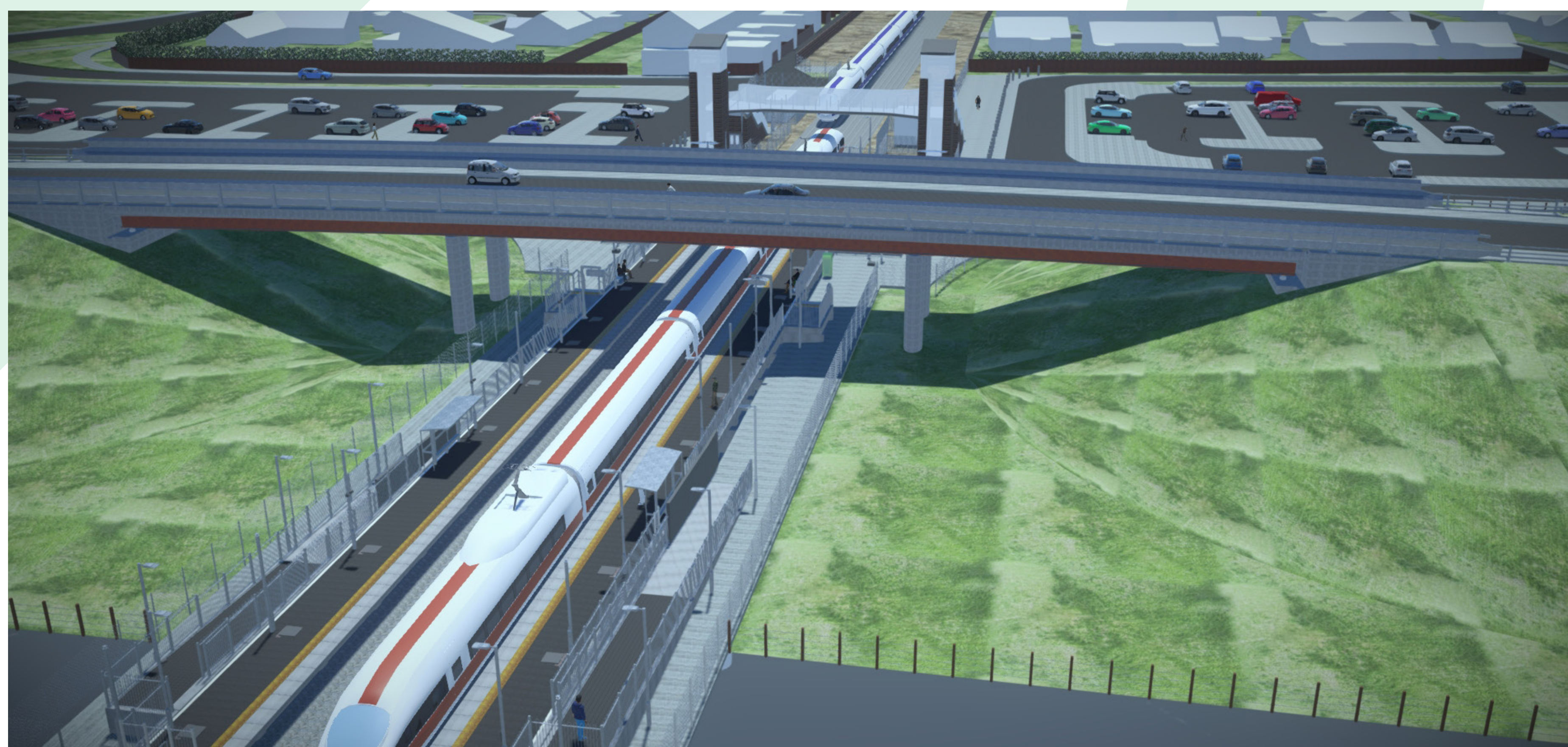

View of Newsham station from above, with station platforms in the foreground and the new highway bridge, footbridge between platforms and station car park in the background

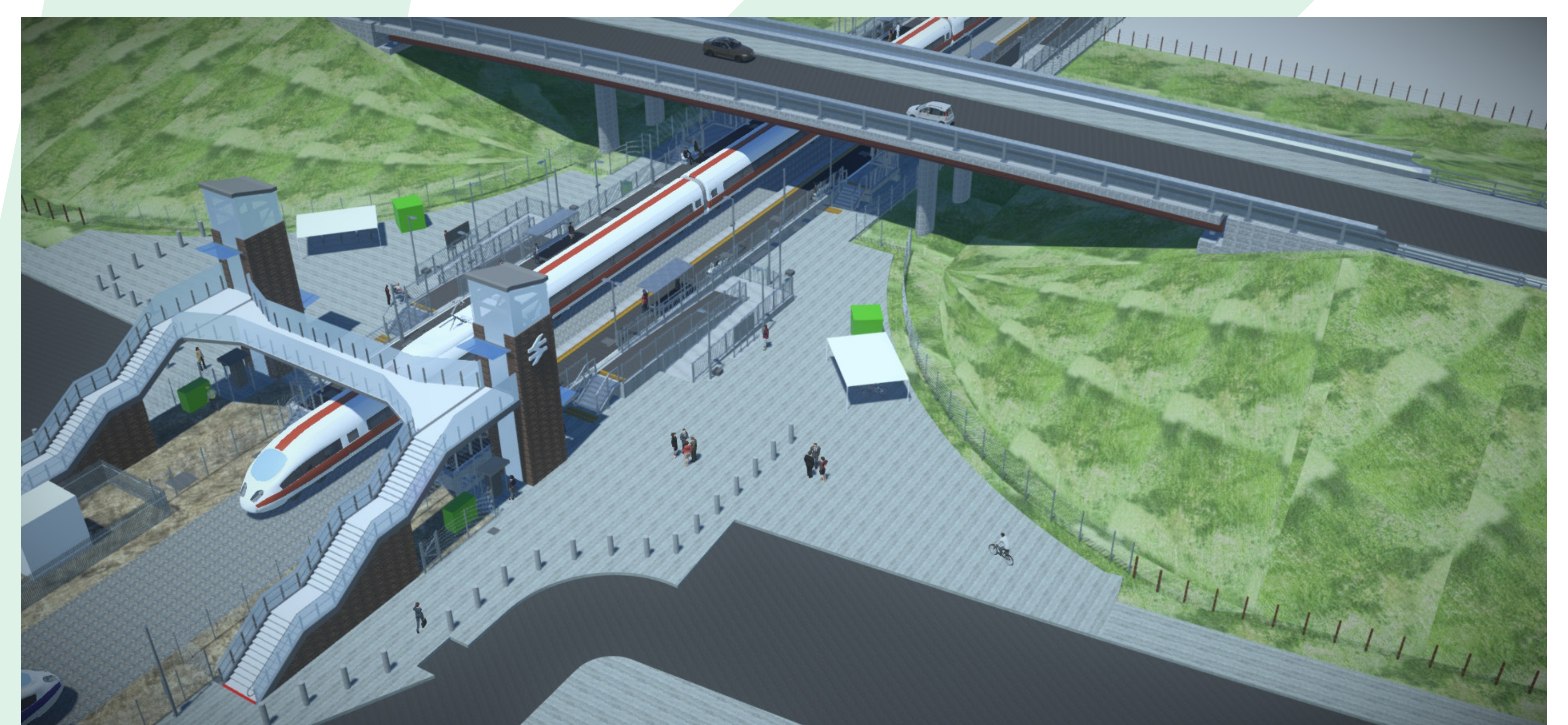

Aerial view of Newsham station from the south, with forecourt including ticket machine and cycle parking and pedestrian bridge between platforms in the foreground

Timeline for Blyth Bebside and Newsham stations



The timeline below shows when we anticipate different construction activities happening for Newsham station, the new highway bridge at Newsham, and Blyth Bebside station. These dates are subject to change, and letters will be sent to local residents in advance of any works on site. You can also sign up to be kept up to date with scheme developments on our project website.

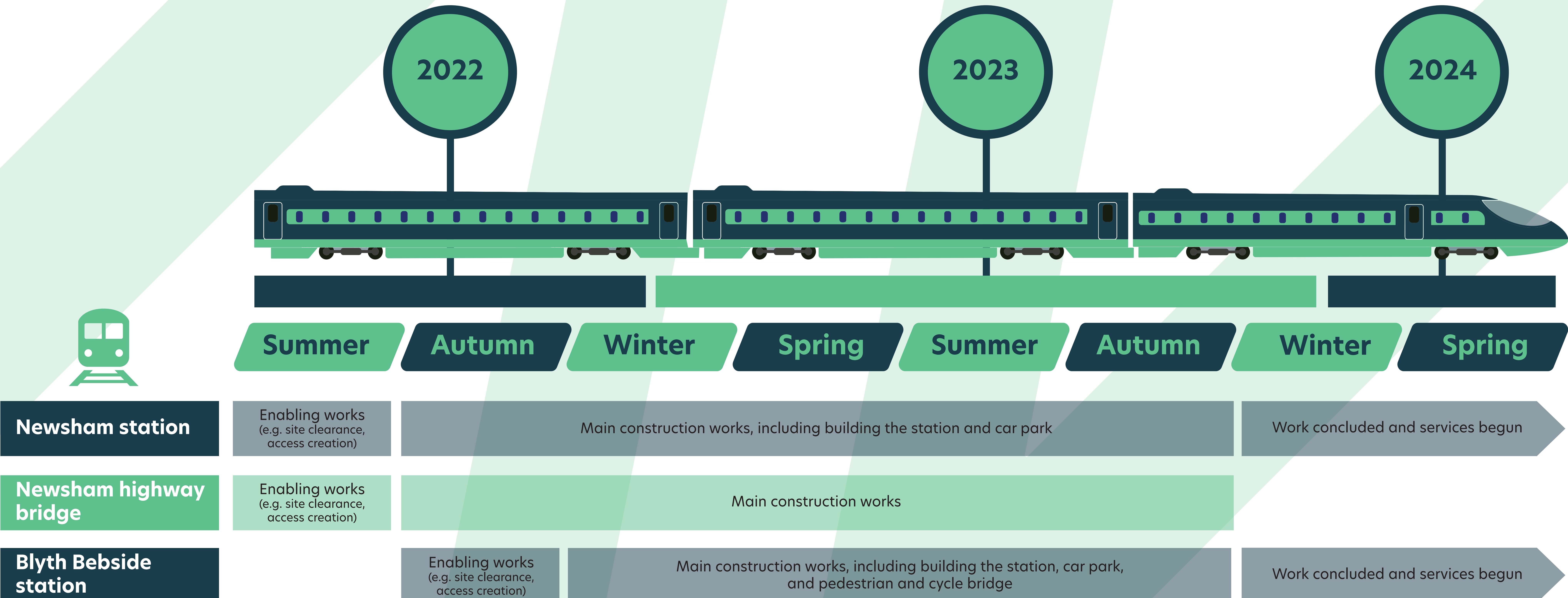

Archaeology at Newsham

During the preparation of land at Newsham for the construction of the new station, archaeological investigations uncovered an ancient site.

The site is believed to be a settlement dating back to the Iron Age / early Romano-British Period. A rectangular enclosure with central circular features was revealed by archaeologists, and is likely to be evidence of round houses.

Further studies have also found a large enclosure ditch surrounding evidence of five round houses in the east of site, suggesting the area was a farming settlement during the Iron Age. Evidence of post medieval farming systems have also been discovered outside the rectangular enclosure.

Further to these discoveries, archaeologists have continued to dig by hand, but no pottery or smaller archaeological items have been discovered. The findings are known as 'soft' archaeological deposits and therefore they will soon be covered up to prevent damage or erosion.

The ancient findings at Newsham have increased our understanding of the prehistoric environments, diets and different farming practices of inhabitants that used to live within south east Northumberland.



"This is a fascinating snapshot into what life was like in our county thousands of years ago.

We know Northumberland has a rich and interesting history and to see it close up is a real find.

As we begin to create our own little bit of history in bringing back passenger trains to this line it's worth remembering that progress and innovation is nothing new."

- Glen Sanderson, Leader of Northumberland County Council



Aerial view of archaeological findings at Newsham, dating back to the Iron Age



Archaeologists conducting investigations at Newsham